



# SILENT DRIVE

## KEROSENE / DIESEL HEATER

### USER'S MANUAL & OPERATING INSTRUCTIONS

# RPK130R



### DANGER

**READ AND UNDERSTAND ALL OF THE INSTRUCTIONS IN THIS MANUAL BEFORE ASSEMBLING, STARTING, OR SERVICING THE HEATER.** Be sure to comply with the instructions and warnings provided with this heater. Failure to comply can result in fire or explosion that can cause property loss, bodily injury, or loss of life. Only persons who can follow and understand these instructions should operate or service this heater. If you need heater info; such as an operating manual, labels, etc. Please visit our website [www.remingtonpower.co.nz](http://www.remingtonpower.co.nz)

**NOT FOR USE IN RESIDENTIAL LIVING AREAS OR IN ENCLOSED SPACES WITHOUT ADEQUATE VENTILATION. FOR OUTDOOR USE.** INDOOR USE PERMITTED ONLY FOR: The temporary heating of adequately ventilated buildings or structures under construction, alteration or repair. This is an unvented portable heater that uses air (Oxygen) from within the area in which it is used. Failure to provide adequate combustion and ventilation air will result in asphyxiation, carbon monoxide poisoning, bodily injury or death. Refer to "Ventilation" on Page 7.

[www.remingtonpower.co.nz](http://www.remingtonpower.co.nz)

## **CONTENTS**

Introduction.....	3
Environmental Protection.....	3
Safety Information.....	3
Product Diagram.....	5
Specifications.....	6
Working Environment.....	7
Clearance Requirements.....	7
Unpacking and Assembling.....	8
Operating Instructions.....	9
Operation.....	9
Operating Principle.....	11
Circuit Wiring Diagram.....	11
Maintenance.....	12
Troubleshooting.....	12
Parts Diagram.....	13
Parts List.....	14
Warranty.....	15

## INTRODUCTION

Your new Remington Heater will more than satisfy your expectations. It has been manufactured under stringent quality standards to meet superior performance criteria. You will find your new tool easy and safe to operate, and, with proper care, it will give you many years of dependable service.



**CAUTION:** Carefully read through this entire Instruction Manual before operating your new Remington Heater. Take special care to heed the Cautions and Warnings.

## ENVIRONMENTAL PROTECTION

Recycle unwanted materials instead of disposing of them as waste. All tools, hoses and packaging should be sorted, taken to the local recycling centre and disposed of in an environmentally safe way.



## SAFETY INFORMATION



**WARNING:** Fire, burn, inhalation and explosion hazard.

Keep combustibles such as building materials, paper or cardboard a safe distance away from the heater as recommended by these instructions. Never use the heater in spaces which contain products such as; gasoline, solvents, paint thinners, dust particles, volatile or airborne combustibles or any unknown chemicals. This is an unvented portable heater. It uses air (Oxygen) from the area in which it is used. Adequate combustion and ventilation

air must be provided. Refer to "Ventilation" on page 7. Bulk fuel storage should be a minimum of 8 metres from heater.



**WARNING:** Do not operate this heater until you have read and thoroughly understand these safety and operating instructions.

Failure to comply with the precautions and instructions provided with this heater can result in death, serious bodily injury, property loss or damage from the hazards of fire, soot production, explosions, burns, asphyxiation or carbon monoxide poisoning. Only persons who can read and understand these instructions should use or service this heater.



**WARNING:** Do not start the heater when excess oil has accumulated.



**WARNING:** Do not start the heater when the chamber is hot.



Look for this icon throughout the manual for helpful tips on how to assemble, use and clean your Silent Drive Heater.



**WARNING:** Risk of indoor air pollution!

The products described in this manual are Kerosene/Diesel direct-fired, forced air heaters. Kerosene/Diesel forced air heaters are primarily intended for use for temporary heating of buildings under construction, alteration or repair. Direct-fired means that all of the combustion products of the heater enter the heated space. This appliance is rated at 98% combustion efficiency, but does produce small amounts of carbon monoxide.



**WARNING:** *Carbon monoxide poisoning may lead to death!*

Carbon monoxide is toxic. Humans can tolerate only small amounts of carbon monoxide and so precautions should be taken to provide proper ventilation. Failure to provide proper ventilation in accordance with the instructions in this manual can result in death. People with breathing problems should consult a physician before using this heater.

Early signs of carbon monoxide poisoning resemble the flu. Symptoms of improper ventilation / carbon monoxide poisoning are: Headache • Dizziness • Nausea • Dry Mouth Sore Throat • Burning of Nose and Eyes

If you experience any of these symptoms: **GET FRESH AIR AT ONCE!** Have your heater serviced and check for proper ventilation. Some people are more affected by carbon monoxide than others. These include: pregnant women, those with heart or lung problems, anemia or those under the influence of alcohol or at high altitudes.

**FOR OUTDOOR USE. INDOOR USE PERMITTED ONLY FOR:** The temporary heating of adequately ventilated buildings or structures under construction, alteration or repair! Provide at least a three square foot (2,800 sq cm) opening of outside air for every 100,000 Btu / Hr heater rating. Refer to "Ventilation" on page 7 for further instructions.



**WARNING:** *Risk of electric shock!*

ALWAYS use only the electrical power (voltage and frequency) specified on the model plate of the heater.

ALWAYS use only three-prong, grounded outlet and extension cord.

ALWAYS unplug the heater when not in use.

ALWAYS install the heater so that it is not directly exposed to water spray, rain, dripping water, or wind.



**WARNING:** *Risk of burns, fire and explosion!*

NEVER use fuels such as gasoline, benzene, paint thinners or other oil compounds in this heater.

NEVER refill the heater's fuel tank while the heater is operating or still hot. This heater is **EXTREMELY HOT** while in operation.

NEVER block air outlet (front).

NEVER use duct work in front of heater.

NEVER move or handle heater while still hot.

NEVER transport heater with fuel in tank.

NEVER use with an external fuel tank.



**CAUTION:** *Hot while in operation. Do not touch. Keep children, animals, clothing and combustibles away from heater.*

#### **Minimum Clearance From Combustibles**

4m from the top, 4m from the sides and 8m from the front.

ALWAYS locate heater on a stable and level surface.

If your heater is equipped with a thermostat, once it is plugged in, it can start at anytime in accordance with the thermostat setting.

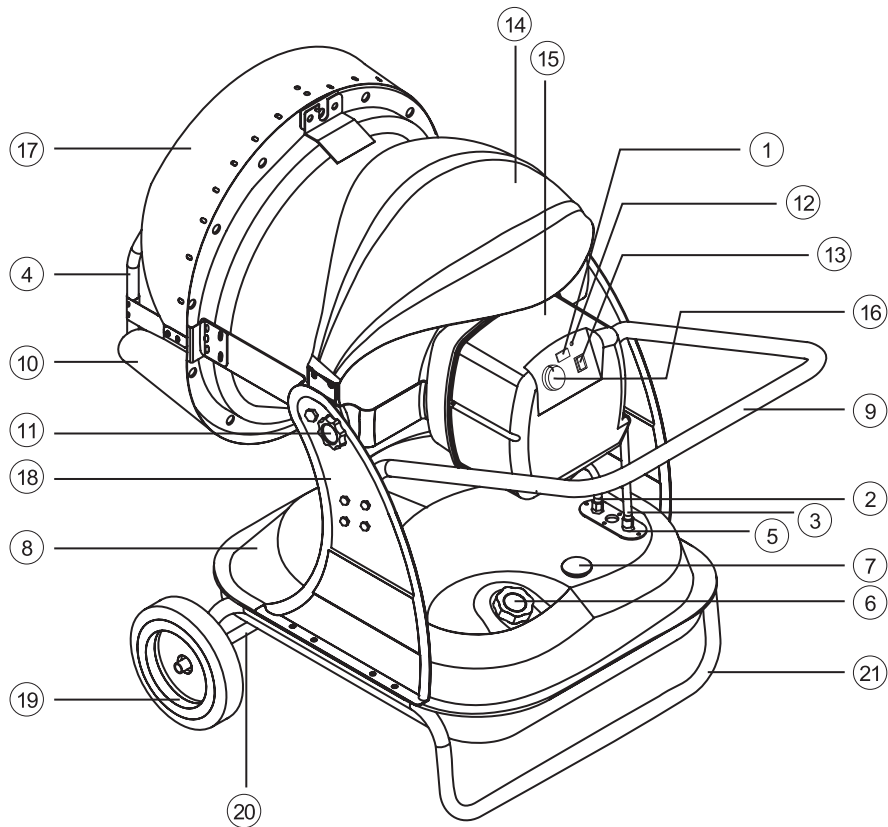
**PRODUCT DIAGRAM**

#	SKU	DESCRIPTION	#	SKU	DESCRIPTION
1		Digital Display	12		Power Indicator
2		Fuel Pipe	13		Power Switch
3		Return Pipe	14		Protective Umbrella
4		Front Guard	15		Rear Cover
5		Filter Access Plate	16		Temperature Control Dial
6		Fuel Cap	17		Upper Reflector
7		Fuel gauge	18		Vertical Supports
8		Fuel Tank	19		Wheel
9		Handle	20		Wheel Axle
10		Lower Reflector	21		Wheel Support Frame
11		Position Adjustment Screws			

## SPECIFICATIONS

Voltage ~ Frequency:	230V ~ 50Hz
Heat Output:	130,000 BTU/Hr (37kW)
Average Heating Area:	300m <sup>2</sup> /h
Fuel Consumption:	3.4L/Hr
Fuel Type:	Diesel / Kerosene
Fuel Tank Capacity:	40L
Maximum Run Time:	12Hrs
Assembled Dimensions (LXWXH):	1155 x 696 x 930
Weight:	34.5kg

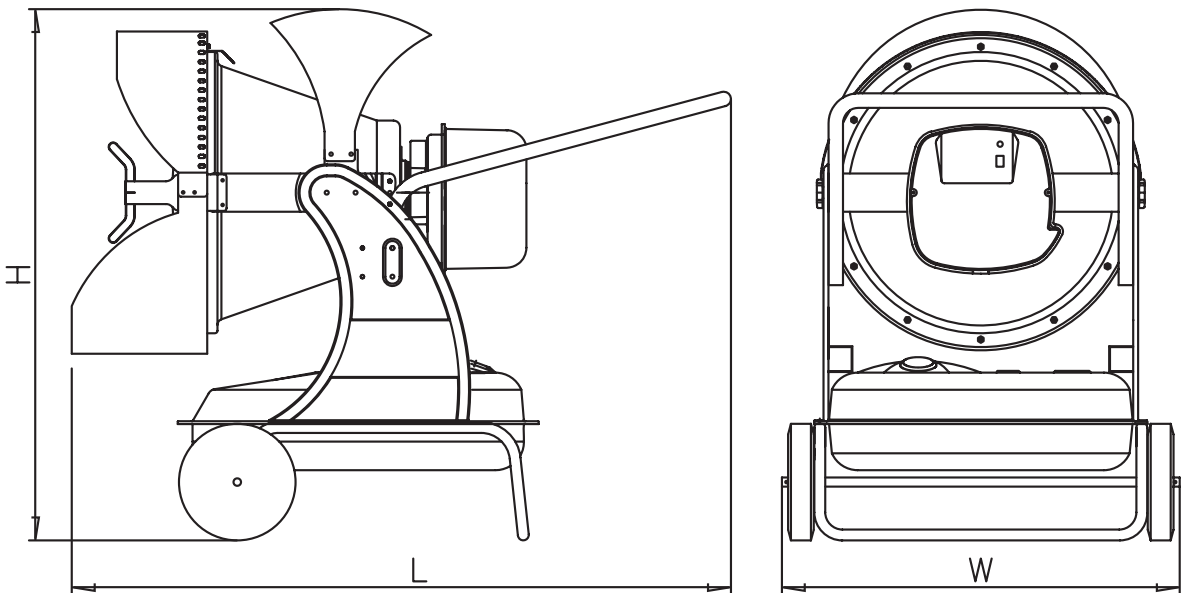

## WORKING ENVIRONMENT



**WARNING!** Only operate and refuel/fuel the heater in well ventilated areas. Careful consideration must be given to the placement of the heater to provide safe and comfortable heating. Ensure continuous ventilation is provided to the heater operating area. A ventilation opening must run to the outside of the premises in which the heater is to be operated

**WARNING:** Small quantities of Carbon Monoxide are released during the combustion process ensure this equipment is only ever operated in safe working environments with sufficient ventilation. Stop the heater immediately if any symptoms are experienced (dizziness, headache, nausea etc.) and seek medical advice.

**WARNING!** Air contaminants taken into the heater may affect the heat output, damage the heater and may cause health problems.

**Example:** Body-shop filler dust/paint overspray will damage the motor bearing, clog the filter and compressor and contaminate the combustion chamber causing flame flutter and health hazards.

**Please note that any parts damaged by filler dust/paint overspray or similar will not be covered by warranty.**

## CLEARANCE REQUIREMENTS

Always provide adequate space around the heater as shown in the diagram and table in (Fig.3) below:

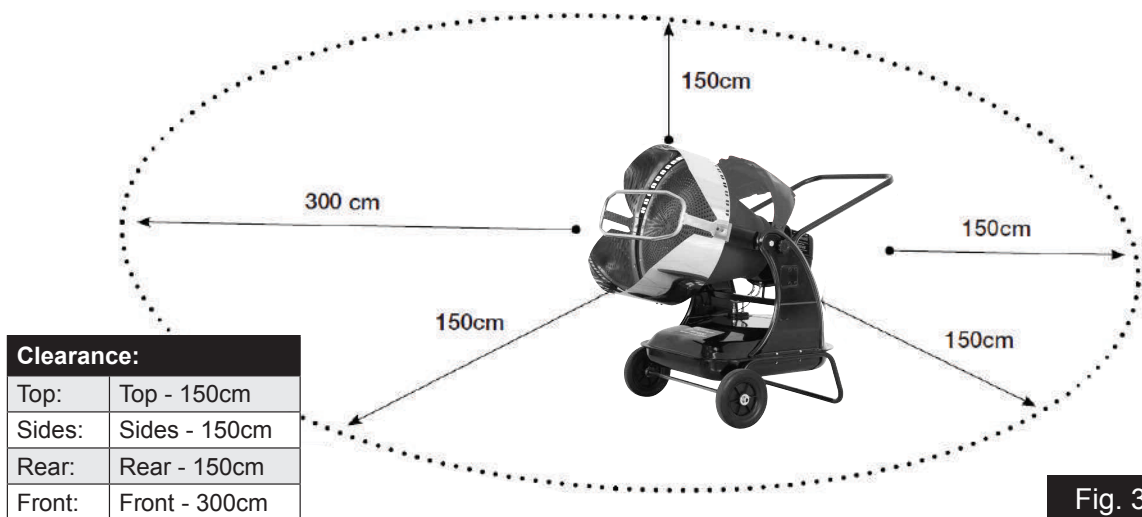
**Fig. 3**

# UNPACKING AND ASSEMBLING

Open the packing box and take out the heater, accessories and manual etc then check.  
 For the contents, refer to the picture.

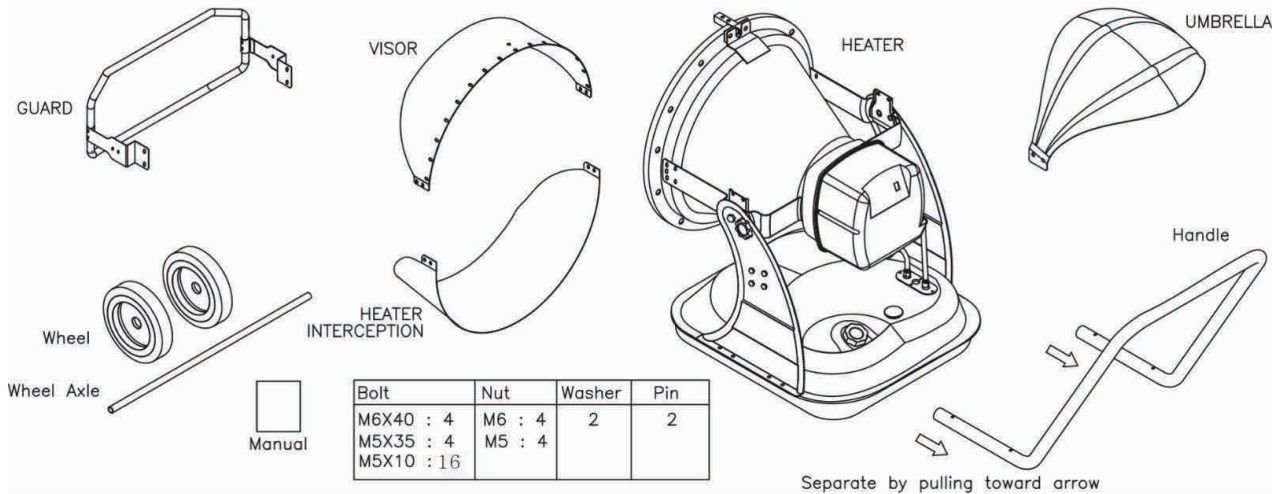

### Assembling. 1

Open the box and take out the Heater. Separate the handle, inserted in Heater by pulling toward arrows

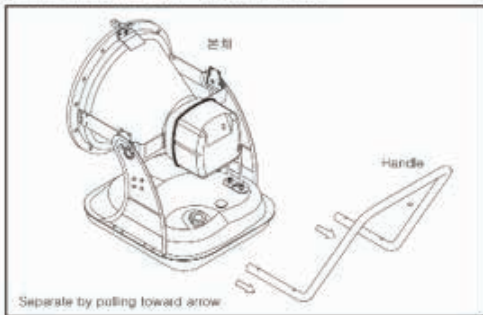

### Assembling. 2

Fix the handle tightly according to the direction on diagram with Bolt(M6X40) and Nut

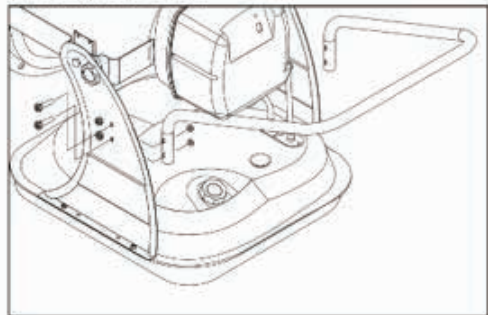

### Assembling. 3

Assemble the Heater on appointed position of wheel Support Frame(described on diagram) with Bolt(M5X35) and Nut According to diagram, After assembling wheel and Wheel Axle, and fix with washer and pin.

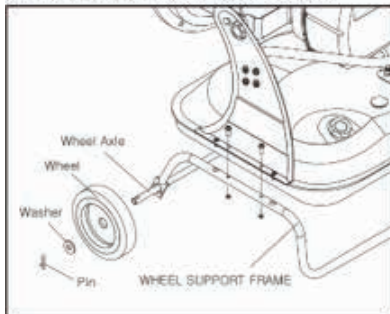

### Assembling. 4

Assemble the Guard using M5X10 Bolt.

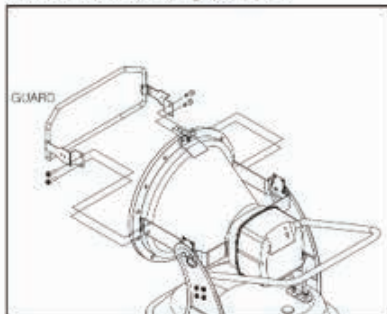

### Assembling. 5

Assemble Visor, Heater Interception and Heat umbrella on the main body using M5X10 Bolt.

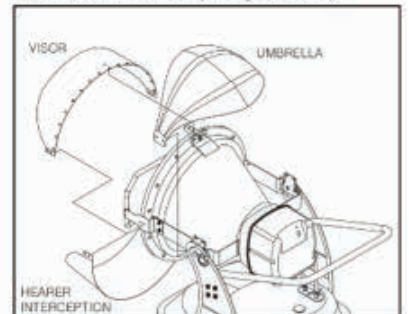

## OPERATING INSTRUCTIONS

### STARTING THE HEATER

1. Fill the fuel tank until the fuel gauge points to "F".
2. Ensure the fuel cap is securely tightened.
3. Plug the mains lead into a suitable power socket and turn the mains switch on.
4. Push the Power switch on the control panel to the "ON" ( I ) position.

**Note:** The temperature that the thermostat is set to will be shown on the display: If the set temperature is lower than the ambient temperature, the heater will not run and after a few seconds the ambient temperature will show on the display.

5. To start the heater, turn the thermostat control clockwise to raise the set temperature (as shown on the display) above the ambient temperature and the heater will run. If the set temperature is higher than the ambient temperature the heater will start to run.
6. Once running the ambient temperature will show on the display.

The set temperature can be adjusted at anytime during operation; Turn the thermostat control left to lower the temperature and clockwise to raise the temperature, at this time the temperature on the display indicates the set temperature and after a few seconds it will change to the ambient temperature.

The heater will run until the ambient temperature goes above the set temperature, at which point the heater will automatically stop running until the ambient temperature drops below the set temperature, or the thermostat is turned up.

### STOPPING THE HEATER

1. Turn the power switch to the "OFF" ( 0 ) position.
2. Combustion will stop and the cooling cycle will begin.
3. When cooling cycle has been completed and the fan stops running (approximately 3 minutes), it is safe to turn off and unplug the heater at the mains supply.

## OPERATION

### Fueling The Heater

#### Kerosene or Diesel

This heater is multi-fuel rated. Kerosene or diesel may be used, or a mixture of the two.

#### Fuel Set - Fuel Conditioner

For optimal performance, it is strongly suggested that Fuel Set fuel conditioner be used in addition to fuel. Diesel contaminants such as diesel bug and water in the fuel may make the heater perform poorly. Add the recommended dose of Fuel Set to every tank of fuel when filling to ensure the RPK130R performs at it's peak.



**DANGER:** *Never refuel this heater while it is hot or operating. Fire or explosion could result.*



**CAUTION:** *Never fill the fuel tank indoors. Always fill the tank outdoors. Be sure that the heater is on level ground when fueling, and never overfill the tank.*



**WARNING:** *Do not use gasoline or crankcase drainings.*

NEVER use fuel such as, benzene, alcohol, white glass, camp stove fuel, paint thinners, or other oil compounds in this heater.

THESE ARE VOLATILE FUELS THAT CAN CAUSE A FIRE OR EXPLOSION.

NEVER store Kerosene in the living space. Kerosene should be stored in a well ventilated area outside the living area.

NEVER store Kerosene in direct sunlight or near a source of heat.

NEVER use Kerosene that has been stored from one season to the next. Kerosene deteriorates over time. OLD Kerosene WILL NOT BURN PROPERLY IN THIS HEATER.



*Kerosene should only be stored in a blue container that is clearly marked "Kerosene." Never store Kerosene in a red container. Red is associated with gasoline.*

## STOPPING THE HEATER

1. Turn the power switch to the "OFF" ( 0 ) position.
2. Combustion will stop and the cooling cycle will begin.
3. When cooling cycle has been completed and the fan stops running (approximately 3 minutes), it is safe to turn off and unplug the heater at the mains supply.



WARNING! Do not turn the mains switch off or disconnect the heater from the mains supply to stop the heater or until the cooling cycle is complete. Turning the mains switch off, or removing the plug from the mains supply to stop the heater or before the cooling cycle is complete may cause overheating, possible damage to the heater and will void the warranty.

## Ventilation

There is a risk of indoor air pollution and Carbon monoxide poisoning. Use heater only in well ventilated areas.

Refer to Safety Information on pages 3 - 4 for information about Carbon Monoxide Poisoning.

Always provide a fresh air opening in the heated space of at least 2.8m<sup>2</sup> (3 sq. ft) for each 100,00 Btu / Hr. of heater output. Provide a larger opening if more heaters are being used.



**DANGER:** *Carbon monoxide poisoning may lead to death!!*

*Minimum ventilation opening required:*  
1951cm<sup>2</sup> - 2.1ft<sup>2</sup>

## OPERATING PRINCIPLE

The Remington RPK130R Radiant Diesel Heater generates up to 130,000 BTU/H (38kW) of infrared heat, which warms objects rather than the air. Infrared heating is similar to the warmth we feel from the sun and makes this heater an excellent solution for heating large, well-ventilated spaces such as garages and warehouses.

Proper combustion requires airflow, which is supplied by the internal burner fan. The air enters the burner funnel and mixes with a high-pressure fuel jet. Fuel flow is maintained by an electric pump, which draws fuel from the tank and delivers it to the nozzle under high pressure.

The RPK130R heater is equipped with safety cut-outs to prevent overheating and protect the unit in the event of a tip-over. Additionally, the heater features a clean and efficient burning system, designed to operate on diesel or kero-sene.



**WARNING:** Do Not Use Petrol or Gasoline Fuel With This Heater!

**Please Note:** When using the heater for the first time, you may notice a slight emission of smoke, or a slight burning smell. This is normal and will stop after a short time. Parts of the heater were coated with protection oil during production. The smoke / smell is caused by any small residue of this oil.

## CIRCUIT/WIRING DIAGRAM

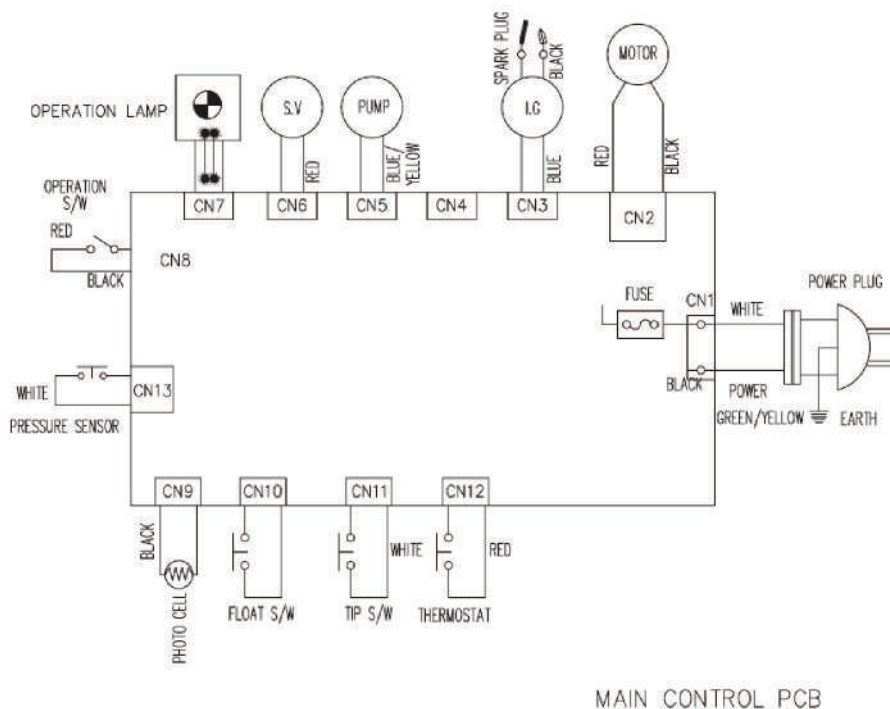

## MAINTENANCE

Component:	Frequency:	Procedure:
Fuel Tank	Clean every 150-200 hours of operation or when necessary	Empty and rinse with fresh fuel.
Nozzle	Clean or replace once per season or when necessary	Contact service agent
Photocell	Clean once per season or when necessary	Contact service agent
Fuel Filter	Clean or replace twice per season or when necessary	Clean the fuel filter with clean fuel.
Ignition Device	Clean or replace every 1000 hours of operation, or when necessary	Contact service agent
Fan Blades	Clean when necessary	Contact service agent

## TROUBLESHOOTING / ERROR CODES

### ⚠ WARNING SAFETY PRECAUTIONS:

If errors occur, refer to the following chart:

	Possible Cause	Solution
E0	Plugged in while switch is on	- Switch heater off, then turn back on
E1	Ignition fault	- Fill the fuel - Change photocell - Clean fuel filter - Check spark plug
E2	Thermostat fault	- Connect Thermostat - Replace Thermostat
E3	Sensor fault	- Turn off until cooled - Reconnect sensor - Replace sensor
E4	Blower Fan is jammed	- Check wire connection - Contact service centre
Lo	Below 9°C	- Normal
Cn	Temp 45 - 59°C	- Normal

**READ AND UNDERSTAND ALL INSTRUCTIONS, CAUTIONS AND WARNINGS IN THE USER'S MANUAL BEFORE ASSEMBLING, OPERATING OR SERVICING THIS HEATER.**

- Use only good quality Diesel or Kerosene.
- Safety distance from heater is 3m
- Use only in well-ventilated areas. Provide at least a 3 sq. foot opening of fresh, outside air for each 100,000 U/hr of rating when running heater.
- Heater is suitable for outdoor / indoor use only in well ventilated areas.
- Keep on a stable and level surface while hot or running to prevent fire.
- Never move, handle, re-fuel or service when hot, operating or plugged in.
- When moving keep heater in an upright level position or fuel spillage may occur. Never store heater while it contains fuel.
- Do not look into exhaust end of heater or block air inlet (rear) or air outlet (front) of heater. Never attach duct work to front or rear of heater.
- Always use a 3 pronged, grounded extension cord.
- Do not use gasoline or crankcase draining for fuel.
- Never fill the unit while the heater is running.
- Service should be done by a qualified technician only.
- Heater should not be used with external fuel tank.
- Never use heater in living or sleeping areas.



## PARTS LIST

#	SKU	DESCRIPTION	#	SKU	DESCRIPTION
1		Fuel Tank	36		Burner Bracket
2		Fuel filter	37		Burner Head Gasket
3-1		Float Sensor	38		In Diffusion
3-2		Float Sensor Packing	39		Control Base
3-3		Fuel Pipe	40		Power Cord
3-4		Return Pipe	41		Cord Bush
3-5		Pipe Packing	42		Return Hose Joint Pipe
3-6		Nut	43		Photocell
3-7		Inlet Fuel Fiter	44		Photocell Bracket
4		Flexible hose	45		Blower Casing
5		Elbow Flexible hose	46		Inlet
5-1		Flexible hose Clamp	47		Blower Motor
6		Fuel Cap	48		Blower Fan
7		Fuel Cap Inner Packing	49		Thermostat
8		Fuel Cap Packing	50		Thermostat Wire
9		Fuel Gauge	51		Igniter
10		Fuel Gauge Packing	52		Electronic Pump
11		Tank Support -L	53		Electronic Pump Pipe
12		Tank Support -R	54		Fuel Filter
13		Cone Body	55		Return Hose
14		Visor Bracket	56		Electronic Pump Base
15		Sticker Bracket	57		Spacer Support
16		Out Diffusion Gasket	58		Main P.C.B
17		Out Diffusion	59		Sub P.C.B &Wire
18		Insulator Body	60		P.C.B Wire
19		Heat Plate	61		Tip Over Switch
20		Cone Body Holder	62		Tip Over Switch Wire
21		Umbrella Bracket	63		Back Cover
22		Bolt	64		Name Plate
23		Nut	65		Power Switch
24		Umbrella	66		Power Switch Wire
25		Rotate ADJ. Handle	67		Spark Plug Cover
26		Support Pipe	68		Handle
27		Guard Bracket	69		Wheel Support Frame
28		Guard	70		Wheel Axle
29		Visor	71		Wheel
29-1		Heater Interception	72		Washer
30		Burner Bracket Gasket	73		Pin
31		Burner Head	74		Pipe Washer
32		Nozzle	75		Pressure Sensor
33		Burner Head Blade	76		Venturi
34		Nipple	77		Pressure Sensor Hose
34-1		Dump Solenoid	78		Thermistor
35		Spark Plug			

## WARRANTY

To validate your warranty, register your product online at [www.remingtonpower.co.nz](http://www.remingtonpower.co.nz)

Whilst every effort is made to ensure your complete satisfaction with this tool, occasionally, due to the mass manufacturing techniques, a tool may not live up to our required level of performance and you may need the assistance of our service department.

This product is warranted for a 12 month period from the date of the original purchase. If found to be defective in materials or workmanship, the tool or the offending faulty component will be replaced free of charge with another of the same item. A small freight charge may apply. Proof of purchase is essential.

We reserve the right to reject any claim where the purchase cannot be verified. This warranty does not include damage or defects to the tool caused by or resulting from abuse, accidents or alterations. It also does not cover any bonus items or included accessories. Only the heater is covered under this warranty.

Please ensure that you store your receipt in a safe place. Conditions apply to the above warranty.

1. **DURATION:** The manufacturer warrants that it will repair or replace, at no charge for parts or labour, the Remington Heater, if proven defective in material or workmanship, during the following time period(s) after date of original retail purchase:

For 1 Year:

This RPK130R Remington Heater

2. **WHO GIVES THIS WARRANTY (Warrantor):**

EUROQUIP NEW ZEALAND  
& EUROQUIP AUSTRALIA  
[www.euroquip.co.nz](http://www.euroquip.co.nz)

3. **WHO RECEIVES THIS WARRANTY (Purchaser):**

The original purchaser of this Remington Heater

4. **WHAT IS COVERED UNDER THIS WARRANTY:**

Defects in material and workmanship which occur within the duration of the warranty period.

5. **WHAT IS NOT COVERED UNDER THIS WARRANTY:**

- A. Implied warranties, including those of merchantability and FITNESS for a particular purpose are limited in duration to this express warranty. After this period, all risks of loss, from whatever reason, shall be on the purchaser.

- B. ANY INCIDENTAL, INDIRECT, OR CONSEQUENTIAL LOSS, DAMAGE, OR EXPENSE THAT MAY RESULT FROM ANY DEFECT, FAILURE OR MALFUNCTION OF THIS PRODUCT.

- C. This warranty does not apply to any accessory or consumable items included with the product which are subject to wear from usage; the repair or replacement of these items shall be at the expense of the owner. These items include, but are not limited to: sparkplugs, seals, o-rings, nozzles, tuning costs, wheels, tyres, bearings, parts, etc. In addition, this warranty does not extend to any damage caused by the untimely replacement or maintenance of any of the previously listed CONSUMABLE parts.

- D. Any failure that results from accident, purchaser's abuse, neglect or failure to operate products in accordance with instructions provided in the owner's manual(s) supplied with the product.

- E. Pre-delivery service, i.e. assembly and adjustment.

6. **RESPONSIBILITIES OF WARRANTOR UNDER THIS WARRANTY:** Repair or replace, at Warrantor's option, products or components which have failed within duration of the warranty period.

7. **RESPONSIBILITIES OF PURCHASER UNDER THIS WARRANTY:**

- A. Please call your re-seller or the number listed above for warranty assistance.

- B. Provide dated proof of purchase and maintenance records.

- C. All generators must be delivered or shipped to the nearest Service Agent or re-seller. Freight costs, if any, must be borne by the purchaser.

- D. Use reasonable care in the operation and maintenance of the products as described in the owner's manual(s).

- E. No warranty costs incurred will be considered for, or covered if Euroquip has not been contacted and prior permission for repair / replacement has been granted.

8. **WHEN WARRANTOR WILL PERFORM REPAIR OR REPLACEMENT UNDER THIS WARRANTY:**

Repair or replacement will be scheduled and serviced according to the normal work flow at the servicing location and depending on the availability of replacement parts.



Congratulations on your new Remington product. We are proud to have you as our customer and will strive to provide you with the best service and reliability in the industry. This product is backed by our extensive warranty and service network. Please contact your local agent or submit a service case online for fast response at [www.remingtonpower.co.nz](http://www.remingtonpower.co.nz) and find the form under the service tab.